

INSTALLATION AND SERVICE MANUAL

LIGMAN
NORTH AMERICA

For Installation of Odessa 1,2,11,12 Floodlights LED.

Model. UOD-50001, UOD-50002, UOD-50011, UOD-50012, UOD-50131 to UOD-50134, UOD-50141 and UOD-50143.

PRODUCT DRAWING (DIMENSIONS)

SUITABLE FOR WET LOCATIONS

ODESSA 1 SMALL FLOODLIGHT

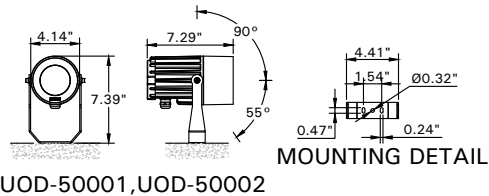

ODESSA 2 MEDIUM FLOODLIGHT

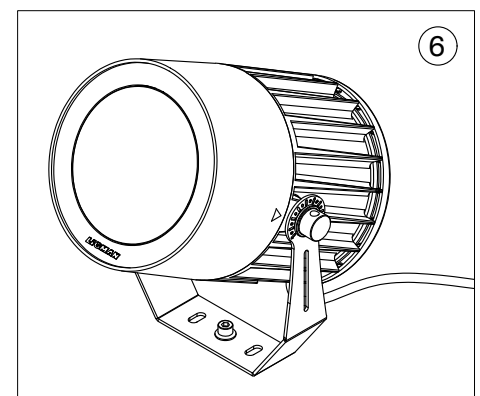
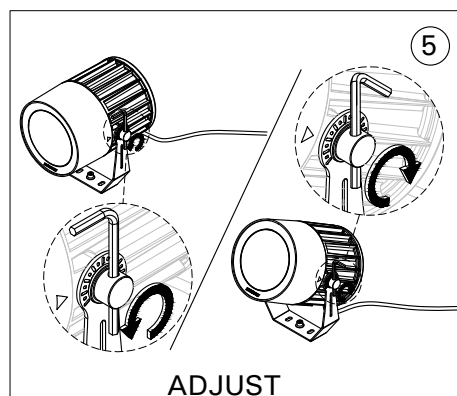
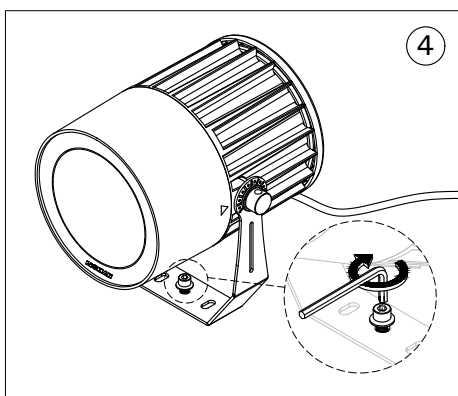
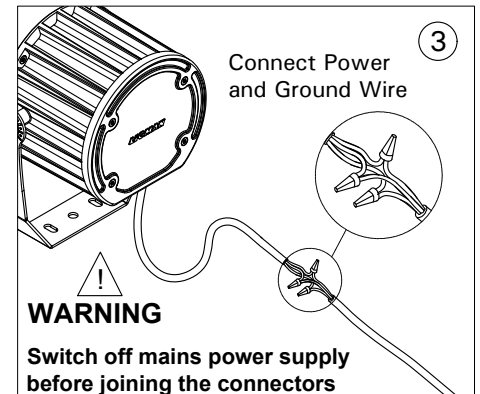
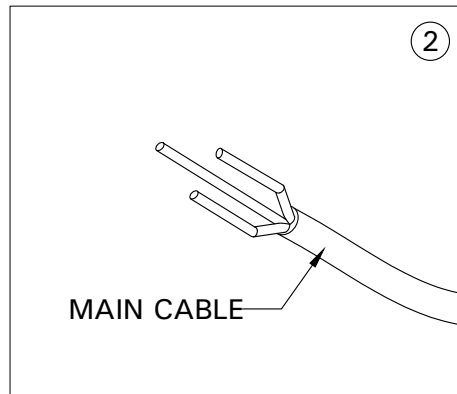
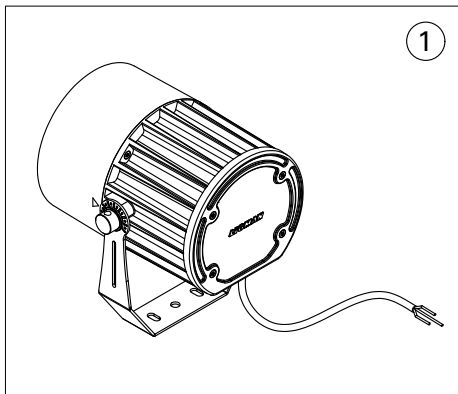
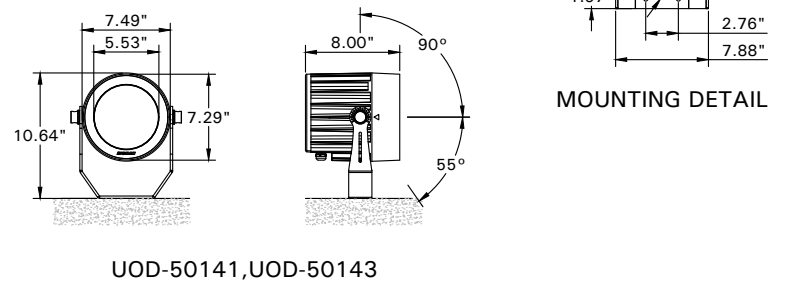
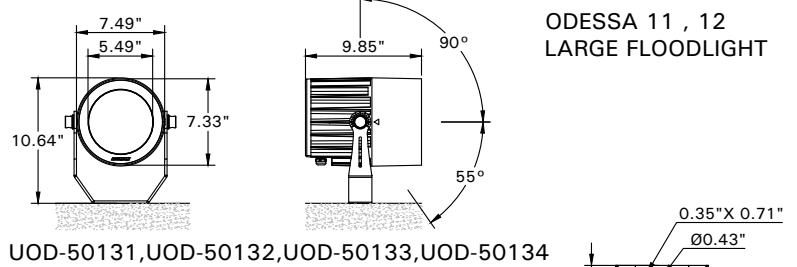
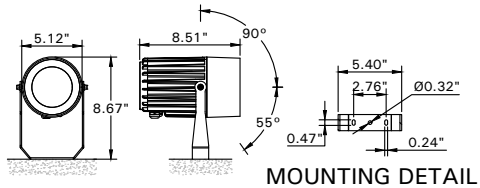

Notice to installer :

WIRING INSTRUCTIONS Warning : RISK OF FIRE AND ELECTRICAL SHOCK. : FIXTURE MUST BE INSTALLED BY A QUALIFIED ELECTRICIAN ONLY>FIXTURE IS INTENDED FOR INSTALLATION IN ACCORDANCE WITH THE NATIONAL ELECTRICAL CODE, LOCAL AND FEDERAL CODE SPECIFICATIONS. DISCONNECT POWER BEFORE SERVICING.

Ligman Lighting USA

7144 NE Progress Court, Hillsboro
Oregon, 97124, USA
Tel : 503 645 0500 | Fax : 503 645 8100